

- LEGEND**
- FOREIGN UTILITIES
 - NORMALLY OPEN
 - NON LOAD-BREAK
 - LOAD BREAK
 - GROUND SWITCH
 - TRANSRUPTER
 - SWITCH
 - FAULT INDICATOR
 - OIL CIRCUIT BREAKER

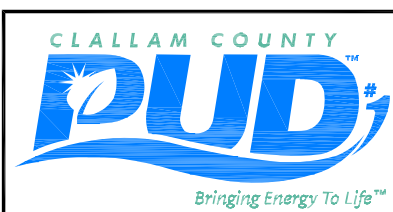

PUBLIC UTILITY DISTRICT
NO. 1 OF
CLALLAM COUNTY
TRANSMISSION SWITCHES
REVISED SEPTEMBER 13, 2023 LEVI LEPPING

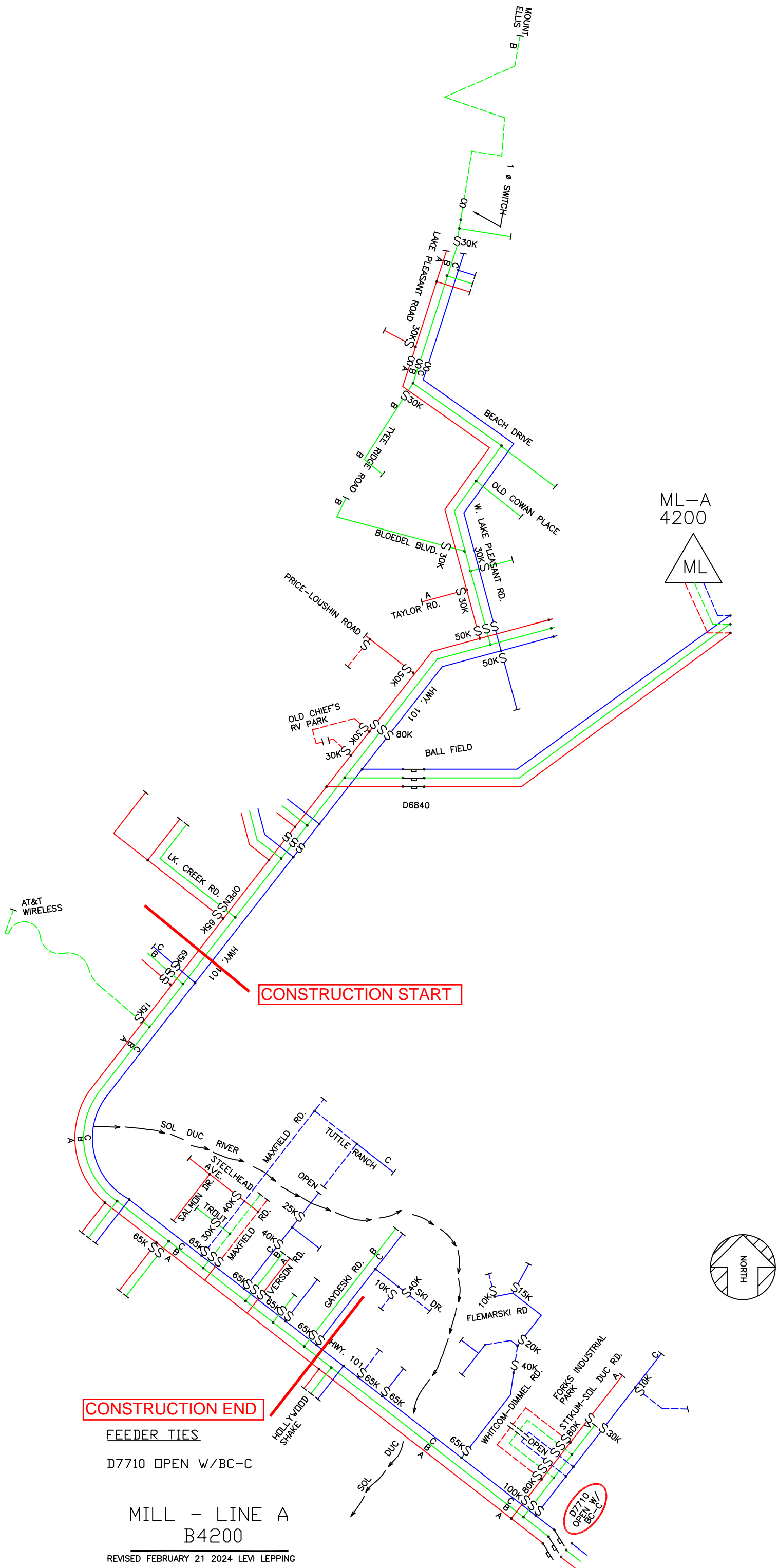

ML-A
4200
ML

CONSTRUCTION START

CONSTRUCTION END

FEEDER TIES
D7710 OPEN W/BC-C

MILL - LINE A
B4200

REVISED FEBRUARY 21 2024 LEVI LEPPING

