

Addendum #1

Carlsborg/Van-Lan Water System Blending, Phase 1 Public Utility District No. 1 of Clallam County

Date Published: October 30, 2023
Date of Addendum #1: October 27, 2023
Date of Bid Opening: November 2, 2023

Notice to All Bidders and Plan Holders

You are hereby notified of the following changes, deletions, additions, corrections, and clarifications to the Plans, Specifications, and other documents comprising the Contract Documents for the above noted Public Utility District No. 1 of Clallam County (District) project.

The following formatting has been used to note deletions (to the original text) and changes/additions to the Contract Documents.

- Deletions are formatted as stricken through (~~example~~).
- Changes/additions to project manual are formatted as underlined (example) or as stated as a global change.
- Changes/additions to plans are clouded  (example).

Bidders must acknowledge receipt of Addendum No. 1 in the space provided in Section A 2, "Proposal", Part 5 in the Bid Form. Failure to comply with this requirement may render the Bid non-responsive and may cause its rejection.

SPECIFICATIONS, PROPOSAL AND CONTRACT DOCUMENTS

I. CONTRACT

1. No changes.

II. SPECIFICATIONS

1. Global – The Contractor shall secure the testing agency for trench backfill and compaction testing.
2. The Table of Contents is REPLACED in its entirety with the attached. The Table of Contents was updated to add Bid Item 26 – Cement Concrete Driveway Repair under Part C Technical Specifications, Section C 2 Descriptions of Work Items.
3. Section A 1, Invitation to Bid, paragraph 5, the first sentence is REVISED to read:

"The Engineer's estimate for the work under this contract is \$ 1,520,306, not including sales tax."
4. The Proposal in Section A 2 is REPLACED in its entirety with the attached. The Proposal was updated to add Bid Item 26 – Cement Concrete Driveway Repair.

5. Section B 2, Article 6.08 A, Permits, the second sentence is REVISED to read:

“The owner is in the process of securing the County right-of-way permit. It will be available at time of Notice to Proceed.”

6. Section B 2, Article 6.11, A 1, second sentence is REVISED to read:

“Contractor shall only store equipment and materials at a site secured by the Contractor.”

7. Section B 2, Article 12, 12.01 C.2e, Contractor’s Fee, is REVISED to read:

“The amount of credit to be allowed by the Contractor to Owner for any change which results in a net decrease in cost will be the amount of the actual net decrease in cost plus a deduction in Contractor’s fee by an amount equal to five percent of such net decrease: and”

8. Section C 1, Item 7, Preconstruction Photographs, the last sentence is DELETED.

9. Section C 2, Bid Item 4 – Temporary Erosion & Sedimentation Control (TESC), is SUPPLEMENTED as follows:

Item A, Description, – “This Work shall include the stabilized construction entrance, with culverts, as shown on the Drawings.”

Item C, Payment, – “Work under this bid item also includes the stabilized construction entrance, including HDPE culverts as shown on the Drawings.”

Item D, Materials – “Stabilized construction entrance materials as shown on the Drawings.”

Item E, Construction Requirements – “Construct the stabilized construction entrance as shown on the Drawings. All stabilized construction entrance materials shall remain after the project completion.”

“Fuse HDPE culvert pipe as described under Section C 2, Bid Item 16, 18-Inch HDPE Pipe DR 17 Casing Pipe.”

10. Section C 2, Bid Item 10 – Controlled Density Fill (As Required) – Controlled Density Fill, Item D, Materials, (4), the Everett No.2 Washed Coarse Sand (SSD) is REVISED to read:

“Washed Coarse Sand.”

11. Section C 2, Bid Item 14 – 8-Inch PVC C900 Water Main – Item D, Materials, (11), paragraph 2, the first sentence is REVISED to read:

“A minimum of one density test shall be taken within every 500 feet of trench length and at depths up to 50% of trench outside of the roadway prism and every 100 feet of trench length and at depths up to 50% and 100% of trench depth for trenches inside of roadway prism, or as directed by the Owner or governing road agency.”

12. Section C 2, Bid Item 16 – 18-Inch HDPE DR 17 Casing Pipe – Item D, Materials, (9), paragraph 2, the first sentence is REVISED to read:

“A minimum of one density test shall be taken within every 500 feet of trench length and at depths up to 50% of trench outside of the roadway prism and every 100 feet of trench length and at depths up to 50% and 100% of trench depth for trenches inside of roadway prism, or as directed by the Owner or governing road agency.”

13. Section C 2, Bid Item 17 – 4-Inch Rigid Non-Metallic Conduit (PVC Sch. 40) – Item D, Materials, (11), paragraph 2, the first sentence is REVISED to read:

“A minimum of one density test shall be taken within every 500 feet of trench length and at depths up to 50% of trench outside of the roadway prism and every 100 feet of trench length and at depths up to 50% and 100% of trench depth for trenches inside of roadway prism, or as directed by the Owner or governing road agency.”

14. Section C 2, Bid Item 26 – Cement Concrete Driveway Repair is ADDED and reads:

26. BID ITEM – CEMENT CONCRETE DRIVEWAY REPAIR

A. Description:

This Work shall include replacing a cement concrete driveway along the new water main alignment, as shown on the Drawings and as described in Section 8-06 of the Standard Specifications, and as modified and supplemented herein.

The private cement concrete driveway, both inside and outside the public right-of-way that is damaged or removed during construction of this Project shall be restored in accordance with these Specifications.

B. Measurement:

Delete Section 8-06.4 of the Standard Specifications and REPLACE with:

“Cement concrete driveway repair shall be lump sum for the work described under this pay item.”

C. Payment:

Delete Section 8-06.5 of the Standard Specifications and REPLACE with:

“The Lump Sum (LS) Contract Price for “Cement Concrete Driveway Repair” shall be full compensation for costs of all the Work, labor, tools, materials, equipment, and incidentals necessary to repair the cement concrete driveway removed for the installation of the water main, as shown on the Drawings. In addition, this work shall include but not limited to sawcutting, removal, haul, and proper disposal of the entire cement concrete driveway, placement and compaction of CSTC or CSBC material prior to placement of new cement concrete, reinforcing steel if required, cement concrete forms, cement concrete, and cement concrete joints and finishing.

Installation of the driveway shall be in accordance with WSDOT Standard Plan Cement Concrete Driveway Entrance, F-180.10-4, Type 4 (attached). New driveway entrance shape, alignment and slope shall match existing. Place and compact a minimum of 4-inches of CSTC material prior to concrete placement. Removal, haul, and disposal of material to accommodate the CSTC material shall be included in this pay item.

All costs for providing and maintaining the driveway with temporary CSBC or CSTC during construction shall be included in this bid item. The Contractor shall coordinate with the property owner prior to construction activities.

If a portion of the existing asphalt shoulder needs to be removed and patched due to this work or is damaged and requires repair due to this work, all costs shall be included in Bid Item 13.

Crushed surfacing material used for driveway base shall be compacted to 95% of maximum density in accordance with ASTM D 1557. Payment for crushed surfacing material and haul shall be included the CSTC or CSBC bid item. Placement and compaction of crushed surfacing material shall be paid under this bid item. Compaction testing shall be paid by the Contractor."

D. Materials:

This Section is SUPPLEMENTED with the following:

"Crushed Surfacing Top or Base Course as described in Section 9-03.9(3) of the Standard Specifications."

III. PLANS:

1. See modifications to C-4 attached.
2. See modifications to C-101 attached.
3. See modifications to EC-114 attached.
4. See modifications to C-114 attached.



John F. Gillespie, P.E.
Project Manager
BHC Consultants, LLC

TABLE OF CONTENTS

PART A - LEGAL AND PROCEDURAL DOCUMENTS

- SECTION A 1 INVITATION TO BID
- SECTION A 2 PROPOSAL
- SECTION A 3 AGREEMENT
- SECTION A 4 PERFORMANCE BOND

PART B - INSTRUCTIONS, CONDITIONS AND REQUIREMENTS

SECTION B 1 INSTRUCTIONS TO BIDDERS

1. Public Opening of Bids
2. Non-Collusion Affidavit
3. Examination of Contract Documents and Site
4. Bid Security
5. Contract Time
6. Liquidated Damages
7. Substitute Material and Equipment
8. Proposal
9. Sales Tax
10. Submission of Bids
11. Modification and Withdrawal of Bids
12. Bids to Remain Open
13. Award of Contract
14. Performance and Other Bonds
15. Signing of Agreement
16. Special Legal Requirements
17. Equal Employment Opportunity
18. 11/2/2023 Copeland Anti-Kickback Act
19. Mandatory Bidder Responsibility Checklist
20. Supplemental Bidder Responsibility Checklist
21. Subcontractor Responsibility Checklist
22. Byrd Anti-Lobbying Amendment Certification

SECTION B 2 GENERAL CONDITIONS

- Article 1. Definitions and Terminology
- Article 2. Preliminary Matters
- Article 3. Contract Documents: Intent, Amending, Reuse
- Article 4. Availability of Lands; Subsurface and Physical Conditions; Hazardous Environmental Conditions; Reference Points
- Article 5. Bonds and Insurance
- Article 6. Contractor's Responsibilities
- Article 7. Other Work at the Site
- Article 8. Owner's Responsibilities
- Article 9. Engineer's Status During Construction

- Article 10. Changes in the Work; Claims
- Article 11. Cost of the Work; Allowances; Unit Price Work
- Article 12. Change of Contract Price; Change of Contract Times
- Article 13. Tests and Inspections; Correction, Removal or Acceptance of Defective Work
- Article 14. Payments to Contractor and Completion
- Article 15. Suspension of Work and Termination
- Article 16. Dispute Resolution
- Article 17. Miscellaneous

SECTION B 3 SUPPLEMENTARY CONDITIONS

- 1. Coordination of Contract Documents, Drawings, Special Provisions, Specifications and Addenda
- 2. Documents
- 3. Order of Precedence of Documents
- 4. Contractor's Insurance
- 5. Contractor's Use of Premises
- 6. Prevailing Wages
- 7. Control of Material
- 8. Shop Drawings and Product Data
- 9. Existing Markers and Monumentation
- 10. Existing Utilities
- 11. Traffic Control and Safety
- 12. Schedule of Values
- 13. Payment for Compaction Testing and Other Special Inspection Testing and Inspections
- 14. Work by Others

PART C - TECHNICAL SPECIFICATIONS

SECTION C 1 GENERAL PROVISIONS

- 1. Location of Work
- 2. Work Covered by Contract Documents
- 3. Soils Investigation
- 4. Estimated Progress Schedule
- 5. Work on Public and Private Rights-of-Way and Easements
- 6. Abandoning Existing Utilities and Fittings
- 7. Preconstruction Photographs
- 8. Governmental Agencies Having Special Interests in the Contract Work
- 9. Special Instructions
- 10. Standard Specifications
- 11. Bid Item Specifications

SECTION C 2 DESCRIPTIONS OF WORK ITEMS

- 1. General
- 2. Bid Item 1 - Mobilization
- 3. Bid Item 2 - Spill Prevention, Control, and Countermeasure (SPCC) Plan
- 4. Bid Item 3 - Storm Water Pollution Prevention (SWPP) Plan
- 5. Bid Item 4 - Temporary Erosion & Sedimentation Control (TESC) Facilities
- 6. Bid Item 5 - Trench Safety Systems

7. Bid Item 6 - Project Temporary Traffic Control
8. Bid Item 7 - Construction Surveying and Staking
9. Bid Item 8 - Force Account
10. Bid Item 9 - Removal and Replacement of Unsuitable Materials
11. Bid Item 10 - Controlled Density Fill (As Required)
12. Bid Item 11 - Crushed Surfacing Top or Base Course
13. Bid Item 12 - Foundation Material Class A and Class B (As Required)
14. Bid Item 13 - Asphalt Concrete Trench Patch
15. Bid Item 14 - 8-Inch PVC Per C900 Water Main
16. Bid Item 15 - 8-Inch DI Pipe CL 52
17. Bid Item 16 - 18-Inch HDPE DR 17 Casing Pipe
18. Bid Item 17 - 4-Inch Rigid Non-Metallic Conduit (PVC Sch. 40)
19. Bid Items 18 and 19 - Gate Valve, Resilient Wedge with Valve Box, 6-, and 8-Inch
20. Bid Item 20 - Connection to Existing Water System
21. Bid Item 21 - Fire Hydrant Assembly
22. Bid Item 22 - Blow-Off Assembly
23. Bid Item 23 - Surface Restoration and Cleanup
24. Bid Item 24 - Minor Changes
25. Bid Item 25 - Record Drawings
26. Bid Item 26 - Cement Concrete Driveway Repair

SECTION C 3 EASEMENTS AND TEMPORARY CONSTRUCTION PERMITS

PART D - DRAWINGS

PART E - PREVAILING WAGE RATES TABLE

PART F - AGENCY PERMITS

PART G - ADDENDA

PART H - CHANGE ORDERS

PART I - GEOTECHNICAL INVESTIGATION REPORT

(END OF SECTION)

SECTION A 2

PROPOSAL

TO: PUBLIC UTILITY DISTRICT NO. 1 OF CLALLAM COUNTY
herein called Owner:

FROM: Proposal of _____
herein called Bidder:

1. GENERAL

The undersigned BIDDER, having investigated the site and locality where the Work is to be performed, the legal requirements (federal, state, and local laws; ordinances; rules and regulations) and the conditions affecting cost, progress or performance of the Work, and being familiar with the contract documents, hereby proposes and agrees, if this bid is accepted, to enter into an agreement with Owner in the form included in the contract documents to complete all Work as specified or indicated in the contract documents and within the contract time indicated in this bid and in accordance with the contract documents for an amount computed upon the basis of the quantity of Work actually performed at the following prices:

Note: Bid amounts shall be shown in both words and figures. In case of discrepancy, the amount shown in words shall govern.

SCHEDULE A – Carlsborg/Van-Lan Water System Blending Project, Phase 1

Item No.	Estimated Quantity	Description of Item	Unit Price	Amount
1.	Lump Sum	Mobilization \$ _____ (Price in Words) Per Lump Sum	\$ _____	\$ _____
2.	Lump Sum	Spill Prevention, Control, and Countermeasure (SPCC) Plan \$ _____ (Price in Words) Per Lump Sum	\$ _____	\$ _____
3.	Lump Sum	Storm Water Pollution Prevention Plan (SWPP) Plan \$ _____ (Price in Words) Per Lump Sum	\$ _____	\$ _____
4.	Lump Sum	Temporary Erosion & Sedimentation Control (TESC) Facilities \$ _____ (Price in Words) Per Lump Sum	\$ _____	\$ _____
5.	Lump Sum	Trench Safety Systems \$ _____ (Price in Words) Per Lump Sum	\$ _____	\$ _____

Item No.	Estimated Quantity	Description of Item	Unit Price	Amount
6.	Lump Sum	Project Temporary Traffic Control \$ _____ (Price in Words) Per Lump Sum	\$ _____	\$ _____
7.	Lump Sum	Construction Surveying and Staking \$ _____ (Price in Words) Per Lump Sum	\$ _____	\$ _____
8.	1	Force Account \$Fifty Thousand Dollars and no Cents (Price in Words) Per Force Account	\$ 50,000.00	\$ 50,000.00
9.	50	Removal and Replacement of Unsuitable Material \$ _____ (Price in Words) Per Cubic Yard	\$ _____	\$ _____
10.	5	Controlled Density Fill (As Required) \$ _____ (Price in Words) Per Cubic Yard	\$ _____	\$ _____
11.	2,340	Crushed Surfacing Top or Base Course \$ _____ (Price in Words) Per Ton	\$ _____	\$ _____
12.	50	Foundation Material Class A and B (As Required) \$ _____ (Price in Words) Per Ton	\$ _____	\$ _____
13.	125	Asphalt Concrete Trench Patch \$ _____ (Price in Words) Per Ton	\$ _____	\$ _____
14.	3,300	8-Inch PVC C900 Water Main \$ _____ (Price in Words) Per Lineal Foot	\$ _____	\$ _____
15.	110	8-Inch DI Pipe CL 52 \$ _____ (Price in Words) Per Lineal Foot	\$ _____	\$ _____
16.	100	18-Inch HDPE DR 17 Casing Pipe \$ _____ (Price in Words) Per Lineal Foot	\$ _____	\$ _____

Item No.	Estimated Quantity	Description of Item	Unit Price	Amount
17.	200	4-Inch Rigid Non-Metallic Conduit (PVC Sch. 40) \$ _____ (Price in Words) Per Lineal Foot	\$ _____	\$ _____
18.	1	Gate Valve, Resilient Wedge with Valve Box, 6--Inch \$ _____ (Price in Words) Per Each	\$ _____	\$ _____
19.	8	Gate Valve, Resilient Wedge with Valve Box, 8-Inch \$ _____ (Price in Words) Per Each	\$ _____	\$ _____
20.	1	Connection to Existing Water System \$ _____ (Price in Words) Per Each	\$ _____	\$ _____
21.	4	Fire Hydrant Assembly \$ _____ (Price in Words) Per Each	\$ _____	\$ _____
22.	1	Blow-Off Assembly \$ _____ (Price in Words) Per Each	\$ _____	\$ _____
23.	Lump Sum	Surface Restoration and Cleanup \$ _____ (Price in Words) Per Lump Sum	\$ _____	\$ _____
24.	Lum Sum/ Allowance	Minor Changes \$ <u>Seventy-Five Thousand Dollars and No Cents</u> (Price in Words) Per Lump Sum	\$ <u>75,000.00</u>	\$ <u>75,000.00</u>
25.	Lump Sum	Record Drawings \$ _____ (Price in Words) Per Lump Sum	\$ _____	\$ _____
26.	44	Cement Concrete Driveway Repair \$ _____ (Price in Words) Per Square Yard	\$ _____	\$ _____
SUBTOTAL:			\$ _____	
SALES TAX (8.6%):			\$ _____	
TOTAL:			\$ _____	

2. BID ITEM

The Bid items are stated only for the purpose of comparing Bids and fixing the amount of surety bonds. The parties hereto should refer to Articles 11.01, 11.02, and 11.03 of the General Conditions, Section B 2 of this Contract, relating to unit price work and possible price changes, in the event of increased or decreased quantities.

3. COMPLETION TIME

BIDDER proposes and agrees, if awarded the Contract, to complete all requirements of the Work within:

- Ninety (90) consecutive calendar days after the Notice to Proceed and as specified.

The successful Bidder will be notified by the Owner or Engineer on the date of Notice to Proceed within 30 days of the Notice of Award.

For purposes of this Contract, substantial completion will be defined as: all water mains and appurtenances installed, tested, and accepted; and all driving surface restoration complete.

BIDDER accepts the provisions of the agreement as to liquidated damages in the event of failure to complete the Work on time.

4. BIDDER'S ACCEPTANCE OF TERMS AND CONDITIONS

Bidder accepts all of the terms and conditions of the Instructions to Bidders, Section B 1 of the Contract, including without limitation those dealing with the disposition of bid security. This bid will remain open for 60 days after the day of bid opening. Bidder will sign the agreement and submit the Performance and Payment Bond, insurance, and other documents required by the contract documents within the time limits set in Owner's Notice of Award.

5. ADDENDA

Bidder has examined copies of all the contract documents and acknowledges receipt of the following addenda:

Addendum No.	Date of Receipt and Acknowledgment
1.	_____
2.	_____
3.	_____
4.	_____
5.	_____

6. ATTACHED BID SECURITY

The following documents are attached to and made a condition of the bid:

Required bid security in the form of _____

Name of Bidder: _____

Signature of Authorized Representative: _____

Name (Print): _____

Title: _____

Date: _____

Address of Bidder: _____

Telephone No.: _____

7. SUBCONTRACTORS LIST (IF REQUIRED BY RCW 39.30.060)

Subcontractor	Category of Work
_____	_____
_____	_____
_____	_____
_____	_____

8. INFORMATION ON BIDDER

Each Contractor bidding on Work included in these Contract Documents shall prepare and submit with the Bid Proposal the data requested in the following schedule of information including the Mandatory Bidder Responsibility Checklist and Subcontractor Responsibility Checklist located at the end of Part B, Section B-1 of the Specifications and referenced in Item 13, Paragraphs A and C of Section B-1. Also, the apparent low bidder and second lowest bidder shall be aware of the bid proposal requirement In Item 13, Paragraph B.

A. Name and License Number of Bidder: _____

B. Years in business under current firm name? _____

C. Contracts now in hand. Gross Amount \$ _____

D. General character of work performed by your company _____

E. List major equipment to be used on this Project and whether it is owned, rented or leased.

F. Bank References (Include Branch) _____

G. List all bonding companies used in the last three years.

H. Name of insurance company (Include Phone Number, Policy Number and Agent's Name)

I. Have you reviewed the insurance requirements as stated in Section B 2 and B 3? ____

J. Can you meet the insurance requirements as stated in Section B 2 and B 3? _____

K. What is your current insurance company's best rating? _____

L. List any claims or suits now pending for which you are either claimant or defendant.

M. A list of all Projects successfully completed by Bidder in last 3 years, which shall include a job description, the name, address, phone number, and contact person of the Owner and the Consultant, the approximate completion date, and the awarded and final contract amounts of each project.

N. The name(s) of the Contractor's proposed superintendent(s) who will be in direct charge of the Project for the full duration of the Contract.

9. NON-COLLUSION DECLARATION

The attached Non-Collusion Form included in these Contract Provisions must be returned with the bid proposal.

10. CONTRACTOR CERTIFIED STATEMENT

The attached Contractor Certified Statement in these Contract Provisions must be returned with the bid.

(END OF SECTION)

NON-COLLUSION AFFIDAVIT

STATE OF WASHINGTON _____)
) ss.
COUNTY OF _____)

_____, The undersigned, being duly sworn, on his oath says that the bid submitted is a genuine and not a sham or collusive bid, or made in the interest or on behalf of any person not therein named; and (s)he further says that the said bidder has not directly or indirectly induced or solicited any bidder on the above work or supplies to put in a sham bid, or any other person or corporation to refrain from bidding; and that said bidder has not in any manner sought by collusion to secure an advantage over any other bidder or bidders.

Firm Name

Authorized Signature

SUBSCRIBED and SWORN to before me this _____ day of _____, 20_____.

Printed Name of Notary Public

Signature of Notary Public

NOTARY PUBLIC in and for the State of
Washington, residing at _____

My commission expires: _____

CONTRACTOR CERTIFIED STATEMENT

Contract No. 230805 to be provided by client.

Contractor certifies to the best of its knowledge and belief that it and its principals:

Within the five (5) year period immediately preceding the bid solicitation date, November 2, 2023, is not a "willful" violator, as defined in RCW 49.48.082, of any provision of Chapters 49.46, 49.48, or 49.52 RCW, as determined by a final and binding citation and notice of assessment issued by the Department of Labor and Industries or through a civil judgment entered by a court of limited or general jurisdiction.

Have not been a party as a plaintiff or defendant in any lawsuits in Washington State Superior or District court in the Puget Sound region (defined as Clallam, King, Kitsap, Pierce, Snohomish, and Thurston Counties) or federal district court for Western Washington in the last five (5) years involving performance or payment issues relating to a public works contract which were resolved adversely to the Bidder through judgment or settlement.

Have not been convicted of a crime involving bidding on public works contract during the five (5) year period immediately preceding the bid solicitation date, November 2, 2023.

Have not been assessed liquidated damages related to the performance of a public works contract by a government agency during the five (5) year period immediately preceding the bid solicitation date, November 2, 2023.

Have not had any public works contract terminated for cause or default by a government agency during the five (5) year period immediately preceding the bid solicitation date, November 2, 2023.

I certify under penalty of perjury under the laws of the State of Washington that the foregoing is true and correct.

Business Name

Signature of Authorized Official*

Printed Name

Title

Date

City

State or country

Check One:

Sole Proprietorship ☐ Partnership ☐ Joint Venture ☐ Corporation ☐

TIN (Tax Identification Number):

State of Incorporation, or if not a corporation, State where business entity was formed:

WA UBI (Unified Business Identifier):

** If a corporation, proposal must be executed in the corporate name by the president or vice-president (or any other corporate officer accompanied by evidence of authority to sign). If a co-partnership, proposal must be executed by a partner.*

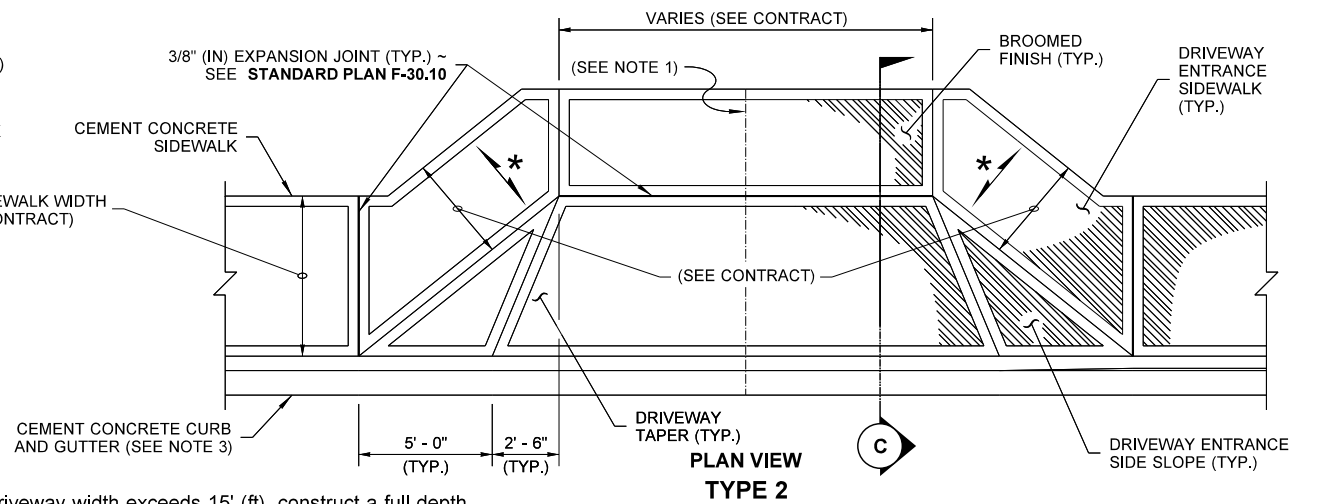
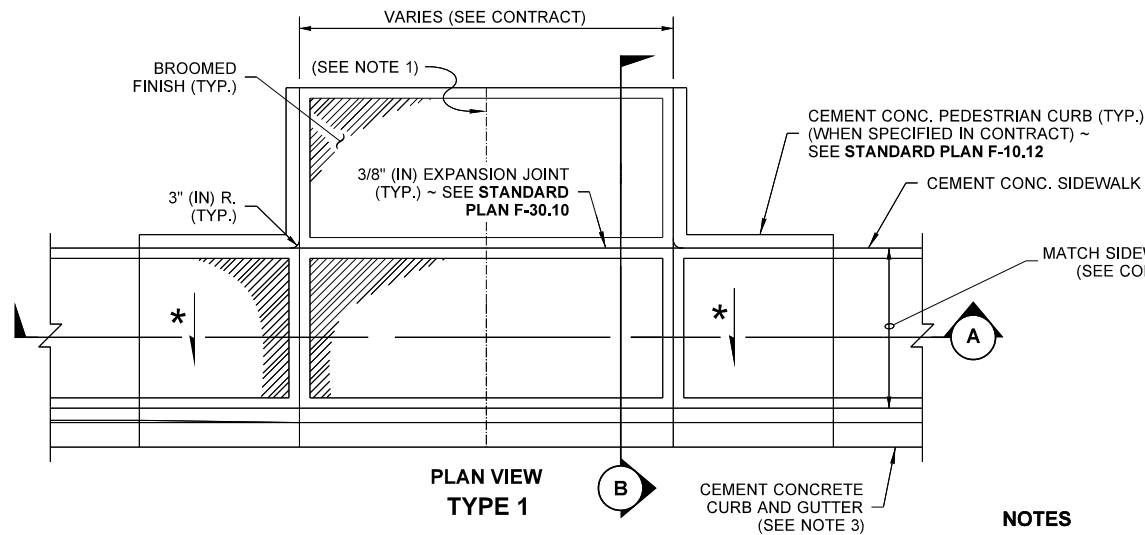

NOTES

1. When the driveway width exceeds 15' (ft), construct a full depth expansion joint with 3/8" (in) joint filler along the driveway centerline. See **Standard Plan F-30.10**. Construct expansion joints parallel with the centerline as required at 15' (ft) maximum spacing when driveway widths exceed 30' (ft).
2. See **Standard Plan F-30.10** for sidewalk details.
3. Curb and Gutter shown; see the Contract Plans for the curb design specified. See **Standard Plan F-10.12** for Curb Details.
4. Avoid placing drainage structures, junction boxes or other obstructions in front of driveway entrances.
5. Where "GRADE BREAK" is called out, the entire length of the line between the two adjacent surface planes shall be flush.
6. The Pedestrian Ramp length is not required to exceed 15 feet (unless otherwise shown in the Contract Plans). When applying the 15-foot max. length (measured from back of sidewalk) the running slope of the pedestrian ramp is allowed to exceed 8.3%. Use a single constant slope from bottom of ramp to top of ramp to match into the sidewalk over a horizontal distance of 15 feet.
7. Beyond limits shown. Pay item does not include driveway. See Contract Plans.

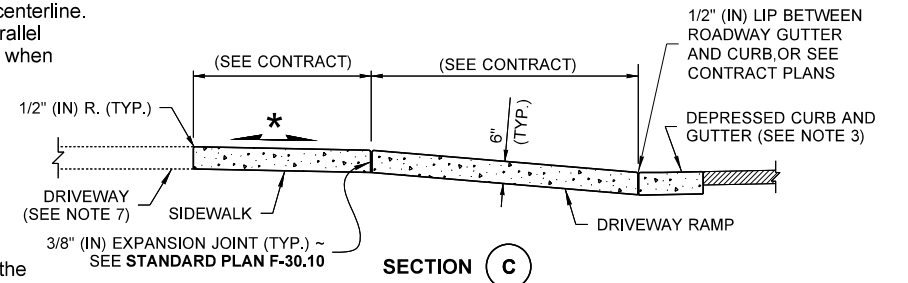
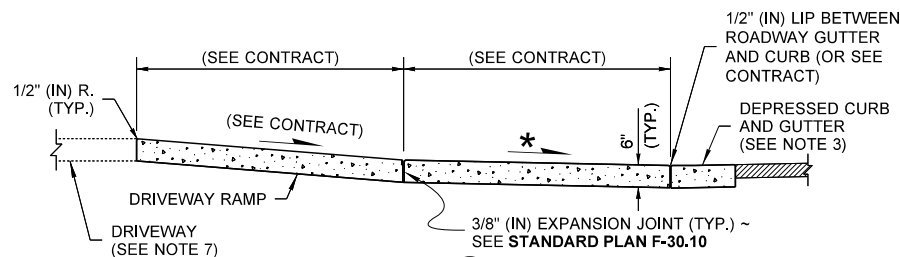
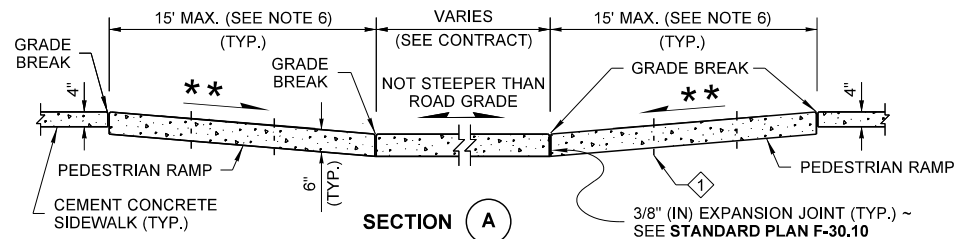

LEGEND

- SLOPE IN EITHER DIRECTION
- * 1.5% OR FLATTER RECOMMENDED FOR DESIGN/FORMWORK (2% MAX.)
- ** 7.5% OR FLATTER RECOMMENDED FOR DESIGN/FORMWORK (8.3% MAX.) (SEE NOTE 6)

"CEMENT CONCRETE DRIVEWAY ENTRANCE TYPE 1" PAY LIMITS

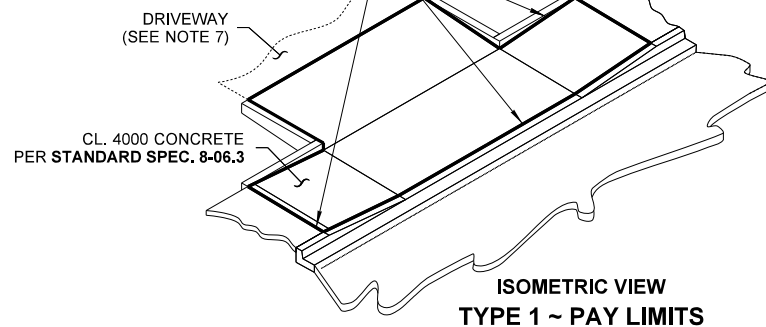

① CONTRACTION JOINT (TYP.) ~ SEE **STANDARD PLAN F-30.10** FOR RAMP LENGTHS GREATER THAN 8' - 0" PROVIDE CONTRACTION JOINT EQUALLY SPACED 4' - 0" MIN. OC.

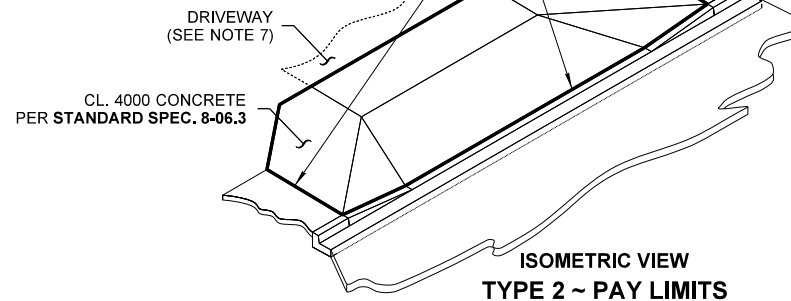

Zeller, Scott
Jul 12 2016 4:26 PM

CEMENT CONCRETE DRIVEWAY ENTRANCE TYPES 1, 2, 3, & 4 STANDARD PLAN F-80.10-04

SHEET 1 OF 2 SHEETS

APPROVED FOR PUBLICATION

Carpenter, Jeff Carpenter, Jeff
Jul 15 2016 2:27 PM

STATE DESIGN ENGINEER



Washington State Department of Transportation

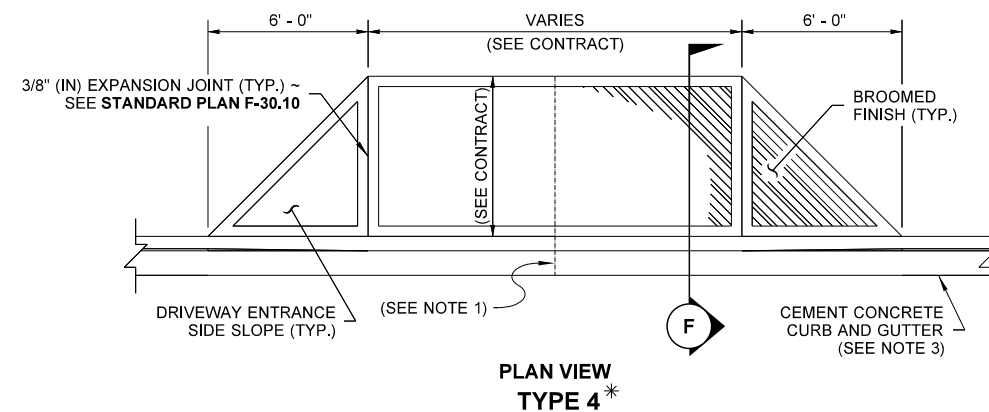
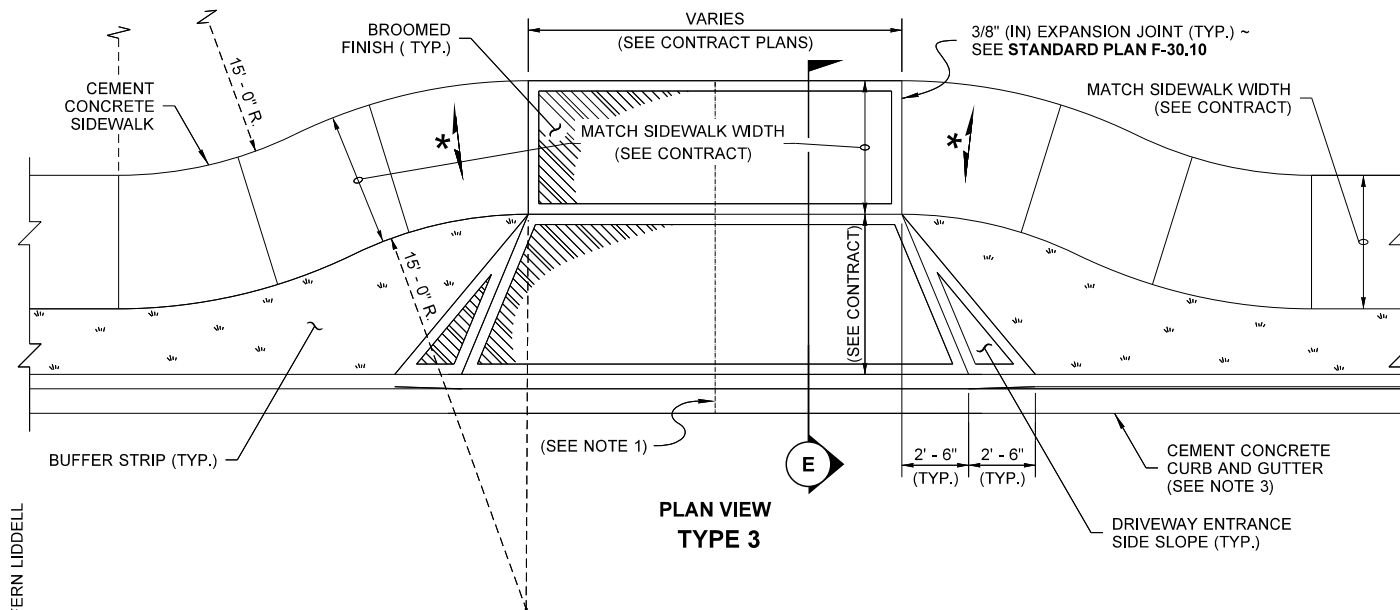

* THIS ENTRANCE TYPE SHALL NOT BE USED ALONG A PEDESTRIAN ROUTE

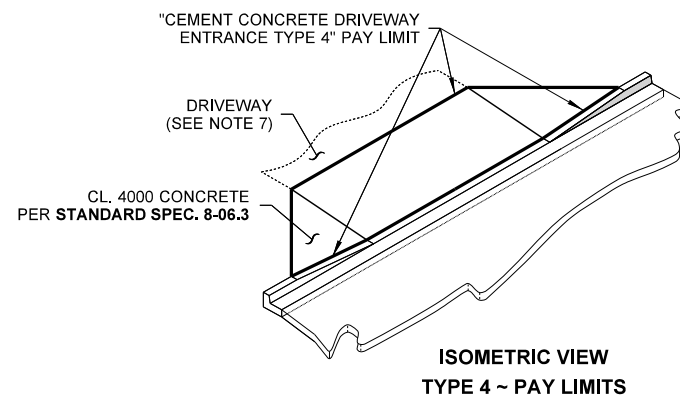
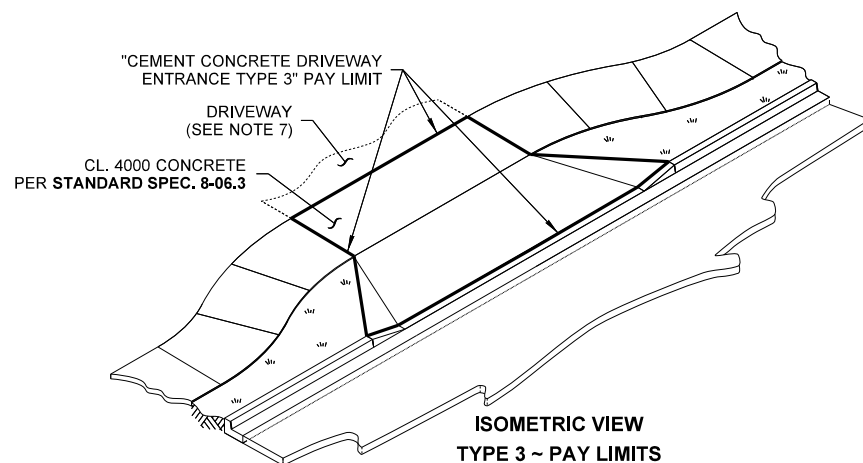
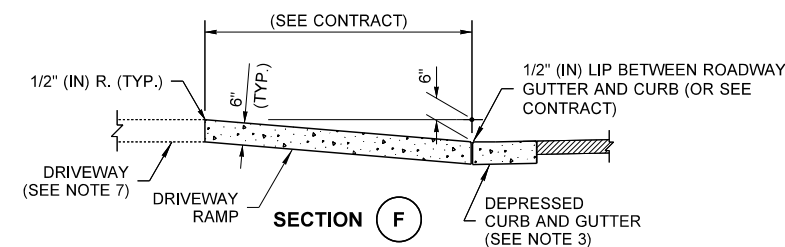
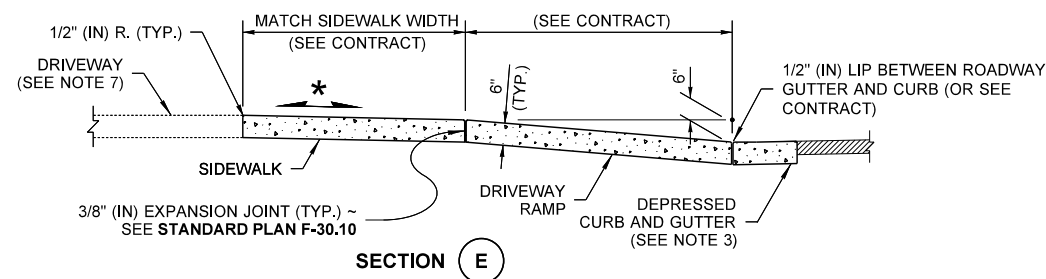

Zeller, Scott
Jul 18 2016 7:07 AM

**CEMENT CONCRETE
DRIVEWAY ENTRANCE
TYPES 1, 2, 3, & 4
STANDARD PLAN F-80.10-04**

SHEET 2 OF 2 SHEETS

APPROVED FOR PUBLICATION

Carpenter, Jeff Carpenter, Jeff
Jul 18 2016 12:22 PM

STATE DESIGN ENGINEER



Washington State Department of Transportation

Path: S:\Cad\Civil\am PUD\22-10806 Carlsborg Van-Lan Water Ph1\ C4 Plot date: Oct 26, 2023-11:43:41am CAD User: psimon.
Xref Filename: | X22-10806 Ph1_TB | Gillespie |

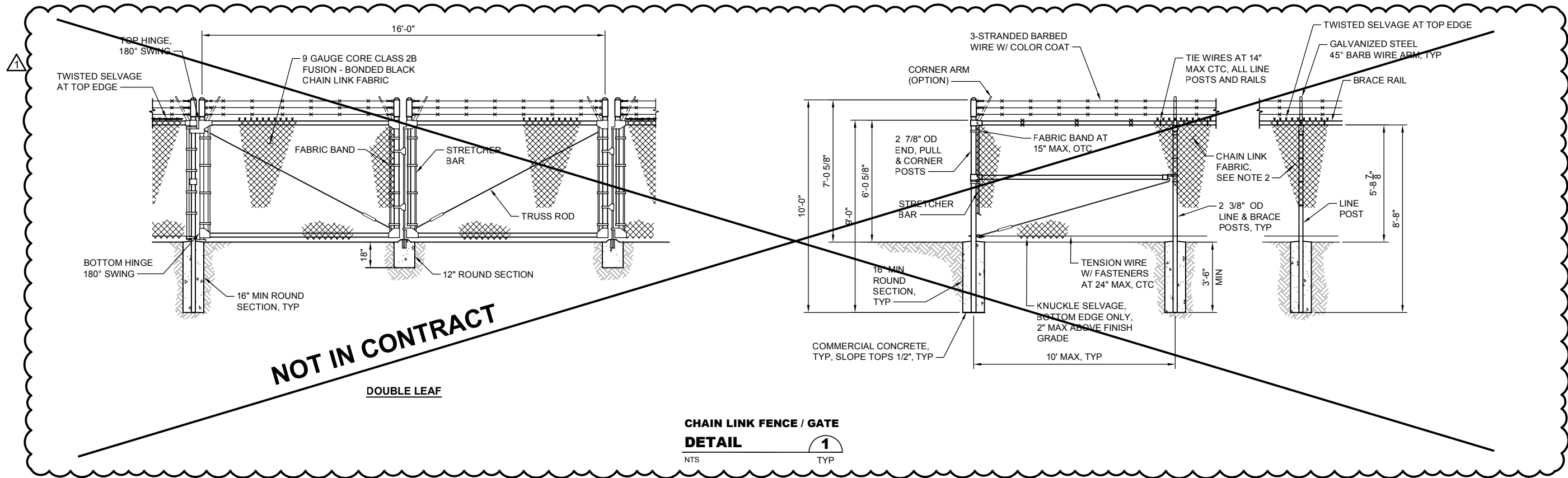

CHAIN LINK FENCE / GATE

DETAIL 1

NTS TYP

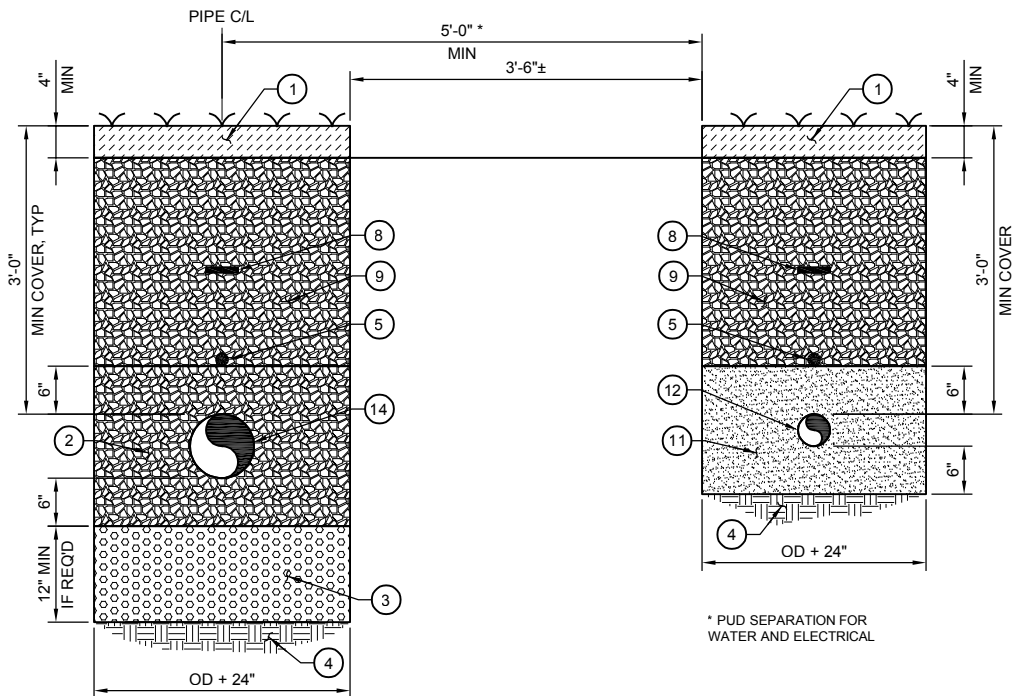

TRENCH IN NON-PAVED AREA
WITH WATER MAIN

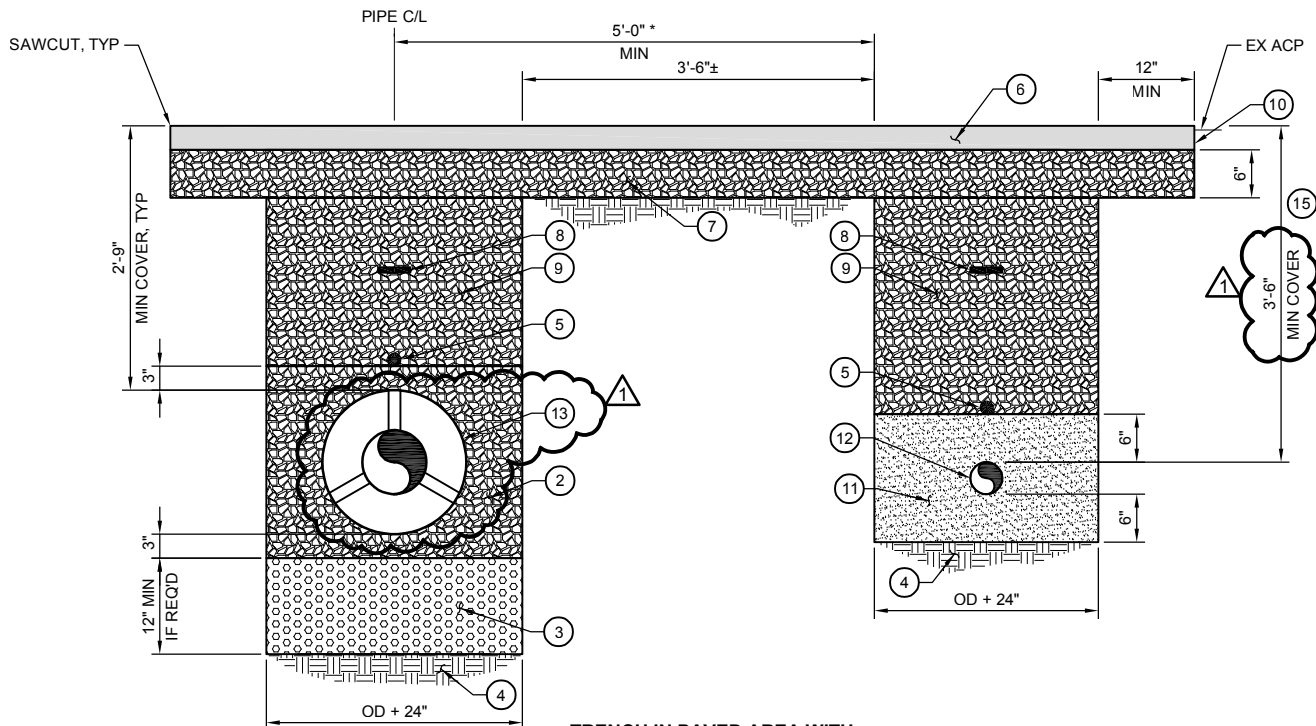

TRENCH IN PAVED AREA WITH
WATER MAIN

TRENCH WITH ELECTRICAL CONDUIT

DETAIL 2

NTS TYP

CONSTRUCTION NOTES:

- 1 TOPSOIL WITH HYDROSEED.
- 2 PLACE CSTC IN 6" LIFTS AND COMPACT EACH LIFT TO 90% MDD IN NON-PAVED AREA AND 95% MDD IN PAVED AREAS PER ASTM D 1557.
- 3 FOUNDATION MATERIAL, CLASS B PER WSDOT STANDARD SPECIFICATION 9-03.17. COMPACT TO 90% MDD PER ASTM D 1557, IF NEEDED.
- 4 COMPACT SUBGRADE.
- 5 10 GAUGE LOCATION WIRE, 6" ABOVE PIPE.
- 6 3" OR MATCH EXISTING THICKNESS, WHICHEVER IS GREATER, HMA CLASS 1/2" PG 64-22. FOR AREAS OUTSIDE OF TRENCH LIMITS, REMOVE EXISTING ACP AND BASE TO A DEPTH OF 9" MINIMUM
- 7 CSTC, COMPACT TO 95% MDD PER ASTM D 1557.
- 8 WARNING TAPE, LOCATED 18" BELOW GRADE.
- 9 PLACE CSTC OR APPROVED NATIVE MATERIAL IN 6" LIFTS AND COMPACT EACH LIFT TO 90% MDD IN NON-PAVED AREAS AND 95% IN PAVED AREAS PER ASTM D 1557.
- 10 TACK COAT
- 11 SAND
- 12 4" PVC SCH 40 ELECTRICAL CONDUIT.
- 13 18" HDPE PIPE DR17 CASING WITH 8" DIP CL52 WATER MAIN AS SHOWN ON DWG C-111.
- 14 8" PVC C900 PIPE
- 15 3'-6" MIN COVER AT DITCH

Call 48 Hours
Before You Dig

1-800-424-5555
UNDERGROUND SERVICE

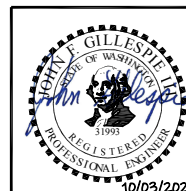

BHC Consultants, LLC
1601 Fifth Avenue, Suite 500
Seattle, Washington 98101
206.505.3400
206.505.3406 (fax)
www.bhcconsultants.com

Designed: Z. Miles, P.E.

Drawn: P. Simon

Checked: J. Gillespie, P.E.

Scale:

NTS

One Inch at Full Scale
If Not One Inch
Scale Accordingly



**PUBLIC UTILITY DISTRICT
NO. 1 OF CLALLAM COUNTY**
104 Hooker Road
Sequim, WA 98382
(360) 452-9771
FAX (360) 681-5474

CARLSBORG/VAN-LAN WATER SYSTEM BLENDING PHASE 1

**CIVIL DETAILS
3 OF 3**

Drawing: **C-4**

Sheet: **11** of **21**

File: P22-10806 Ph1_C-4

Date: October 2023

Path: S:\Cad\Clallam PUD\22-10806 Carlsborg Van-Lan Water Ph1\1d Filenames: P22-10806 Ph1_C-111-114 Plot date: Oct 26, 2023 11:48:51am CAD User: psimon.
Xref Filename: [X22-10806 Ph1_TB | Gillespie | X22-10806 Ph1_Align+Prof | X22-10806 Ph1_Prop Wtr-A | X22-10806 Ph1_Ex Topo | X22-10806 Ph1_Prop Site-A]

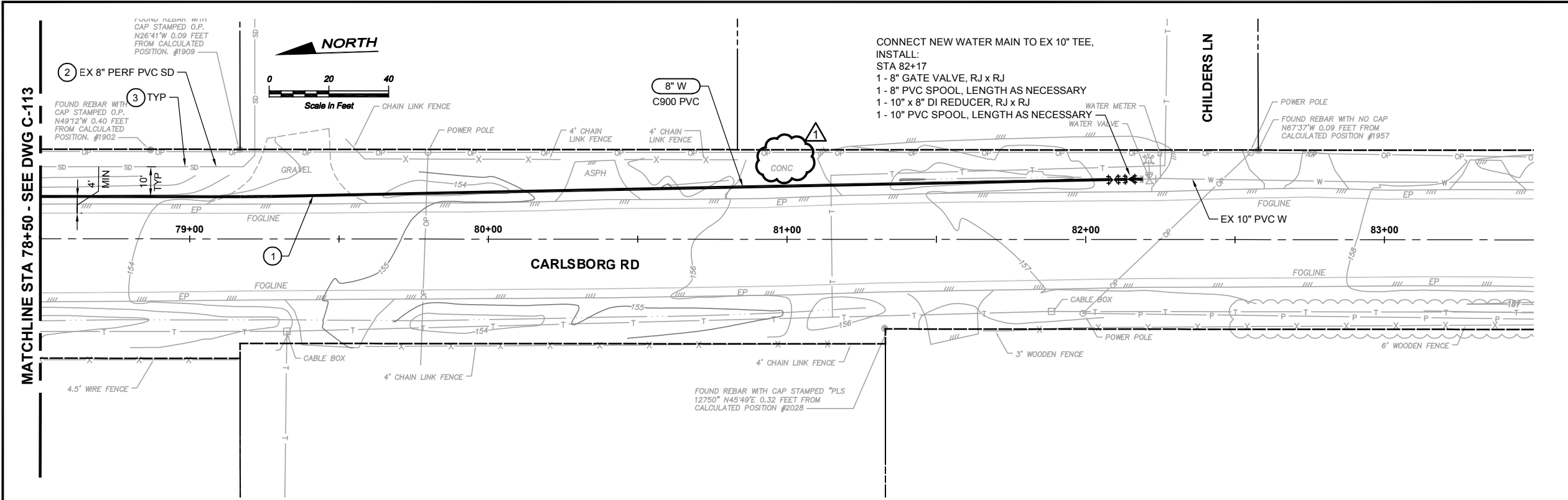

NOTES:

1. ALL TRENCHES SHALL BE COMPLETELY BACKFILLED WITH CSBC OR PLATED AT THE END OF EACH WORKING DAY.
2. ALL TRENCH CUTS SHALL BE SAWCUT (MORE THAN ONCE IF NECESSARY) AND INSPECTED AND APPROVED BY CLALLAM COUNTY PUBLIC WORKS PRIOR TO ORDERING THE TRENCH PATCH HMA. THE CONTRACTOR SHALL RE-CUT TRENCH EDGES AND PATCH ASPHALT PAVEMENT DUE TO CONSTRUCTION ACTIVITIES PER THE COUNTY'S INSPECTION. FOR PRIVATE ROADS AND PAVEMENT, THE ENGINEER WILL INSPECT THE TRENCH CUTS AND ASPHALT PAVEMENT ALONG THE TRENCH.

CONSTRUCTION NOTES:

- ① PIPE TO BE INSTALLED NO CLOSER THAN 4' FROM FOG LINE.
- ② IRRIGATION LINE VARIES 2-FT TO 5-FT FROM OBSERVATION STATIONS. NEW WATER MAIN TO BE INSTALLED A MINIMUM 10-FT FROM IRRIGATION LINE.
- ③ PRIOR TO EXCAVATION, CONTRACTOR SHALL POT HOLE TO LOCATE IRRIGATION LINE. CONTRACTOR SHALL MEASURE AND RECORD DISTANCE FROM IRRIGATION LINE TO EDGE OF PAVEMENT AND PROVIDE TO THE PUD AND ENGINEER.

**Call 48 Hours
Before You Dig**

1-800-424-5555
UNDERGROUND SERVICE

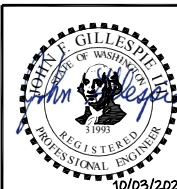

Drawing:	C-114
Sheet:	21 of 21
File:	P22-10806 Ph1_C-111-114
Date:	October 2023

△	ADDENDUM NO. 1	10-2023	ZJM	JFG
	ISSUED FOR BID	10-2023	ZJM	JFG
No.	Revision	Date	By	App'd



BHC Consultants, LLC
1601 Fifth Avenue, Suite 500
Seattle, Washington 98101
206.505.3400
206.505.3406 (fax)
www.bhcconsultants.com

Designed: Z. Miles, P.E.

Drawn: J. Lira

Checked: J. Gillespie, P.E.

Scale:

1" = 20'-0"

One Inch at Full Scale
If Not One Inch
Scale Accordingly



**PUBLIC UTILITY DISTRICT
NO. 1 OF CLALLAM COUNTY**
104 Hooker Road
Sequim, WA 98382
(360) 452-9771
FAX (360) 681-5474

CARLSBORG/VAN-LAN WATER SYSTEM BLENDING PHASE 1

**VAN-LAN
WATER MAIN PLANS
STA 78+50 TO 82+50**