

C:\Users\Zach\AppData\Local\Temp\AcPublish_8824\20-2926-WA-W 9-16 - 3-2-22.dwg

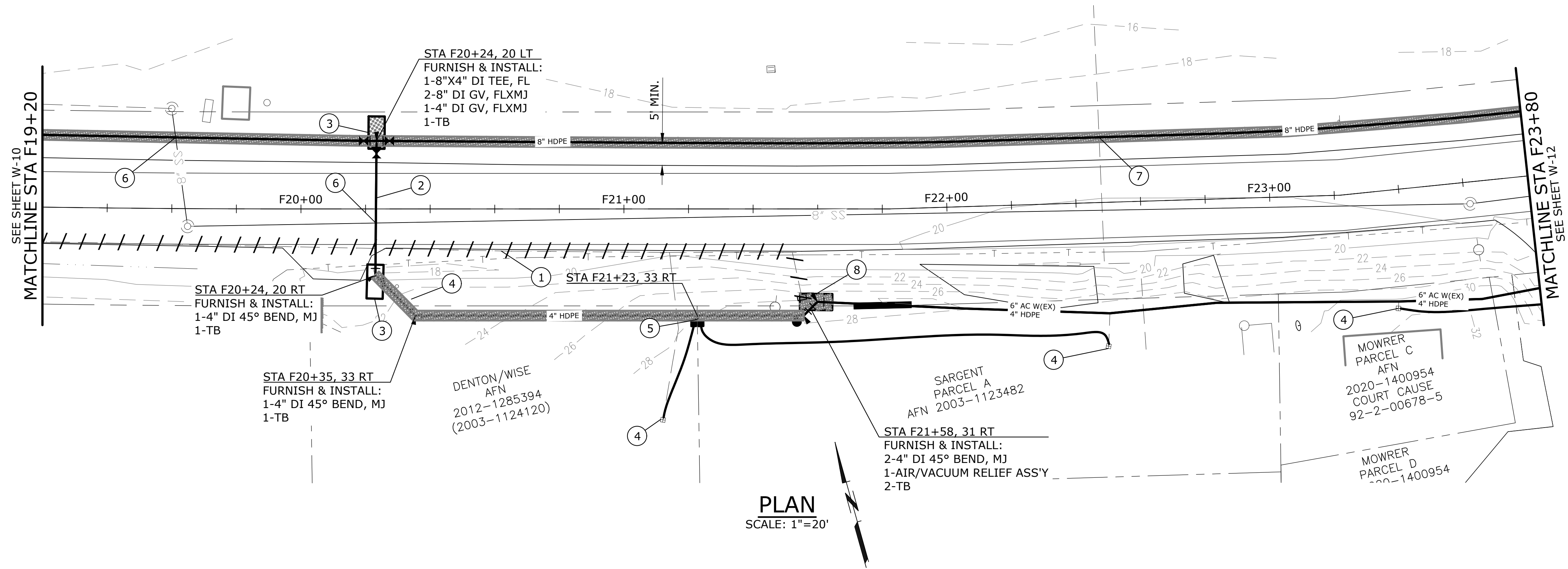

APPROX. LIMITS OF OPEN TRENCH INSTALLATION FOR 4" WATER MAIN PIPE BURSTING INSTALLATION LIMITS FOR 4" WATER MAIN

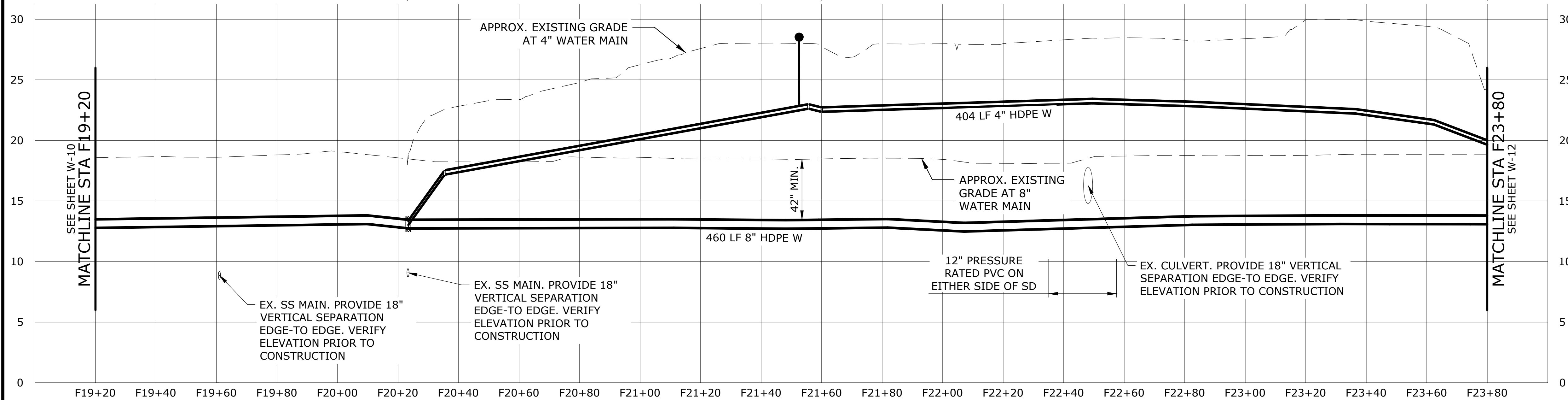

CONSTRUCTION NOTES:

1. DISCONNECT, CAP, AND ABANDON IN PLACE EXISTING 6" AC WATER MAIN.
2. INSTALL WATER MAIN ACROSS HIGHWAY VIA HORIZONTAL DIRECTIONAL DRILLING. ENCASE WATER MAIN INSIDE 12" STEEL CASING WITH CASING SPACERS 5' FEET BEYOND EDGE OF HWY PAVEMENT. MAINTAIN 60" MIN. OF COVER OVER CASING. SEE DETAIL.
3. APPROX. HDD PIT. (15' X 5')
4. REMOVE METER/VALVE BOX & ABANDON EXISTING DISTRICT SIDE SERVICE LINE.
5. INSTALL: NEW DUAL SERVICE METER INSTALLATION PER CLALLAM COUNTY PUD STANDARD DETAIL. CONNECT TO EXISTING CUSTOMER SIDE SERVICE LINES.
6. PROTECT EXIST. SS MAIN. MAINTAIN MINIMUM VERTICAL SEPARATION OF 18" MEASURED EDGE-TO-EDGE.
7. INSTALL WATER MAIN WITHOUT DISTURBING EXISTING CULVERT OR DRAINAGE FLOWS. PROTECT AND SUPPORT CULVERT WHILE WATER MAIN IS INSTALLED. BACKFILL EXCAVATIONS UNDER THE CULVERT WITH CDF. MAINTAIN MINIMUM VERTICAL SEPARATION OF 18" MEASURED EDGE-TO-EDGE.
8. APPROX. PIPE BURSTING PIT (15' X 5')

TESC NOTES:

1. EMPLOY STRAW WATTLES AT ROADSIDE DITCHES TO PREVENT SILTATION FROM ENTERING DITCH FLOW.

TRAFFIC CONTROL NOTES:

1. EMPLOY TRAFFIC CONTROL PER WSDOT STANDARD TRAFFIC CONTROL DETAILS. SEE SHEET T-1.

NOTES:

1. CONTRACTOR MUST VERIFY ALL UTILITY LOCATIONS, SIZE, AND TYPES BEFORE BEGINNING CONSTRUCTION.
2. CONTRACTOR TO PROTECT ALL EXISTING UTILITIES THROUGHOUT THE DURATION OF THE PROJECT.
3. INSTALL PROPOSED WATER MAIN AT CONTINUOUS RISING SLOPE TO AVOID INTERMEDIATE HIGH POINTS.

RESTORATION LEGEND

- RESTORE SURFACE WITH SOIL AND HYDROSEEDING, SEE DETAIL 1, SHEET 1.
- RESTORE HMA SURFACE WITH ASPHALT.
- RESTORE SURFACE WITH 6" MIN. CSTC TO MATCH EXISTING CONDITIONS.

NO.	DATE	BY	REVISION

NOTICE

0 1/2 1

IF THIS BAR DOES NOT MEASURE 1" THEN DRAWING IS NOT TO SCALE

ZNS DESIGNED
MML DRAWN
ZNS CHECKED



WATER PLAN & PROFILE
HWY 112: FALLS CREEK BRIDGE TO BREAKWATER

PROJECT NO.: 20-2926 SCALE: AS SHOWN DATE: FEBRUARY 2022